

広島市原爆死没者慰霊式並びに平和祈念式

HIROSHIMA PEACE MEMORIAL CEREMONY

2024

## 取 材 要 領

PRESS COVERAGE REGULATIONS

令和 6 年（2024 年）8 月 6 日

August 6, 2024

広 島 市

The City of Hiroshima

# Contents

Program.....	1
1. Basic Regulations.....	2
2. Press Areas.....	4
3. Pre-Ceremony Coverage at the Cenotaph and Other Locations.....	5
4. Special Regulations for Coverage.....	5
5. Traffic Restrictions on the Day of the Ceremony.....	5
6. Press Waiting Room.....	6
7. Free Download of Pictures.....	6
<b>Map 1</b> Limited Access Area.....	7
<b>Map 1-2</b> Ceremony Coverage at the Cenotaph and Other Locations.....	8
<b>Map 2</b> Hiroshima Peace Memorial Ceremony Site Plan (Press Areas).....	9
<b>Map 3</b> Press Area 7 (Museum Rooftop) Meeting Point.....	11
<b>Map 4</b> August 6 Traffic Restrictions.....	12
<b>Map 5</b> Press Waiting Room (International Conference Center Hiroshima).....	13
<b>Attachment 1</b> Press Coverage Application Form.....	14
<b>Attachment 2</b> Written Pledge.....	15

## 式次第

## Program

開 式	8 : 00	Opening
原爆死没者名簿奉納 広島市長 遺族代表	8 : 00	<b>Dedication of the Register of the Names of the Fallen Atomic Bomb Victims</b> Mayor of Hiroshima Representatives of the bereaved families
式 辞 広島市議会議長	8 : 03	<b>Address</b> Chairperson of the Hiroshima City Council
献 花 調整中	8 : 08	<b>Dedication of Flowers</b> T B D
黙とう・平和の鐘	8 : 15	<b>Silent Prayer and Peace Bell</b>
平和宣言 広島市長	8 : 16	<b>Peace Declaration</b> Mayor of Hiroshima
放 鳩		<b>Release of Doves</b>
平和への誓い こども代表	8 : 24	<b>Commitment to Peace</b> Children's representatives
あいさつ 調整中	8 : 29	<b>Addresses</b> T B D
ひろしま平和の歌	8 : 46	<b>Hiroshima Peace Song</b>
閉 式	8 : 50	<b>Closing</b>

# Press Coverage for the Peace Memorial Ceremony

Coverage for the Peace Memorial Ceremony (herein “the Ceremony”) on Tuesday, August 6, 2024, must adhere to the following regulations. We thank you for your cooperation.

**Inability to adhere to these regulations may result in the rejection of your press coverage application.** We appreciate your understanding regarding this matter.

Note that **the content of these regulations is subject to change** in response to management and security needs.

## 1. Basic Regulations

### (1) Approved Organizations

In principle, permission to cover the Ceremony is granted to the following organizations only:

#### a) Media Organizations

##### i. Japanese Media

- Member companies of the Japan Newspaper Publishers and Editors Association
- Member companies of the National Association of Commercial Broadcasters in Japan
- Member companies of the Hiroshima City Press Club (herein City Press Club)

##### ii. Foreign Media

1. Member companies of the Foreign Press in Japan (FPIJ)
2. Foreign media organizations that apply via the Foreign Press Center (who do not fall under 1.)

**Note:** In addition to submitting a Press Coverage Application, you must also apply to the Foreign Press Center. Please attach a copy of your Foreign Press Registration Card issued by the Ministry of Foreign Affairs (only applicable to Foreign Press Registration Card holders) or a copy of your ID issued by the media organization you belong to. If you are freelance, attach a copy of a letter from the media organization you have been contracted by.

#### Submit applications to:

Media Relations Division, Foreign Press Center (ma@fpcjpn.or.jp)

#### b) Non-media Organization

- Public institutions
- Cable television broadcasters, local radio stations, filming and production companies

#### c) Others

- Organizations deemed equivalent to the above by the City of Hiroshima’s Public Relations Division.

### (2) Limited Access Area (Map 1)

See Map 1 regarding entry to the Limited Access Area from 5 am. To bypass baggage inspection and other formalities when entering the Limited Access Area (includes re-entry), you must wear a Press Pass issued by the City of Hiroshima and a company armband.

### (3) Press Areas and Press Passes (Map 2)

- a) For security reasons and to ensure the Ceremony proceeds with due dignity, the press is restricted to designated Press Areas. Those covering the Ceremony in these areas **must wear a Press Pass issued by the City of Hiroshima (see right) and a company armband.**
- b) Please make sure to wear the Press Pass around your neck and the armband on your left arm so that they are clearly visible to security personnel.



Also, when filming or photographing following the ceremony, we ask that you wear your company armband so that you can be identified as press.

- c) Press Passes are color-coded according to each Press Area. Before submitting your Press Coverage Application, please carefully confirm which area you would like to apply for. **One pass per person.**

Please see 2. *Press Areas* for information on the areas, Press Pass colors, restrictions, etc.

#### (4) Press Coverage Application

##### **Documents to Submit**

- Press Coverage Application Form (Attachment 1)
- A copy of any Foreign Press Registration Cards (if applicable)
- Written Pledge for Press Coverage from Museum Rooftop (Attachment 2)

**Note:** Only applies if applying for a Press Pass for Press Area 7 (Museum Rooftop) (Map 2)

For security purposes, the documents you provide may be shared with the police or other organizations. Thank you for your understanding.

##### **Submission Deadline**

12 pm, Sunday, August 4, 2024 (Late submissions will not be accepted)

City Press Club members: 5 pm, Monday, July 29, 2024 (Late submissions will not be accepted)

##### **How to Submit Documents**

Submit documents in person or via email.

##### **Where to Submit Documents**

Public Relations Division, Planning and General Affairs Department, City of Hiroshima  
Hiroshima City Hall 11F, 1-6-34 Kokutaiji-machi, Naka-ku, Hiroshima  
Japan 730-8586

**Tel:** (+81) 82-504-2116

**Email:** pr-koho@city.hiroshima.lg.jp

If you submit via email, we will reply with a PDF version of your processed application form.

**Please contact us if you do not receive a reply within three days after submitting your application form.**

#### (5) Collecting Your Press Pass

##### **Where to Pick Up Your Pass**

Public Relations Division, Hiroshima City Hall 11F

##### **What to Bring**















- The business card(s) of the person(s) collecting passes.
- Photo ID (employee ID, passport, etc.) Note: We may check your ID.
- **If you applied by email: a printout of the processed application form which we sent back to you after receiving your application (for ID purposes).**

##### **When You May Collect Your Pass**

**From 9 am, July 25 (Thurs) until 12 pm, August 5 (Mon)**

- If you are unable to collect your Press Pass during this time due to unavoidable circumstances, please come to the press reception desk within the Ceremony venue between 6:30 am and 7 am on August 6 (Tues), and we will issue your pass then. **Press Passes will not be issued after 7 am on August 6.**
- See Map 1 regarding entry to the Ceremony venue from 5 am. **Please arrive with plenty of time to spare as crowding is expected.**

## 2. Press Areas (See Map 2 for the locations of each area)

Area		Filming/ photography	Press Pass Color	Access		Number of People Permitted		Restricted Movement Period <sup>1</sup>
				City Press Club	Other	TV	Newspapers /news	
①	Journalist Seating <sup>2</sup>	×	 Green	✓	✓	1 per company	1 per company	7:20 am until end of Ceremony
②	Radio Broadcaster Seating	×	 Orange	Hiroshima City broadcasters only		Hiroshima City broadcasters only (minimum number of people necessary)		7:20 am until end of Ceremony
③	Cenotaph Southeast <sup>3</sup> (triangle area)		 Red/ Yellow			2 from rep. company (1 camera)	1 per company	7:20 am until end of Ceremony
④	Cenotaph Surroundings <sup>4</sup> (For the Dedication of the Register of the Fallen Atomic Bomb Victims)	✓	 Red	✓ (Includes local cable TV)	×	2 per company (1 camera)	1 per company	The duration of these portions of the program
⑤	Cenotaph Surroundings <sup>4</sup> (For the Dedication of Flowers)		 Red			2 from rep. company (1 camera)	1 per company	
⑥	Cenotaph Surroundings <sup>4</sup> (For the Hiroshima Peace Song)		 Red					
⑦	Museum Rooftop <sup>5</sup>	✓	 Blue	✓ (Includes local cable TV)	×	2 per company (1 camera)	1 per company	7:20 am until end of Ceremony
⑧	Last Row of General Seating	✓	 Blue	✓	×	2 from rep. company (1 camera)	—	7:20 am until end of Ceremony
⑨	Central Walkway South	✓	 Blue	✓	×	2 from rep. company (1 camera)	—	7:20 am until end of Ceremony
⑩	Central Walkway <sup>6</sup>	✓	 Navy	✓	×	4 from rep. company (2 cameras)	1 from rep. company	7:20 am until leaving <sup>7</sup>
⑪	Footpath East <sup>8</sup>	✓	 Purple	✓	✓	• 2 per company (1 camera) • 2 from rep. company (1 camera)	1 per company	7:20 am until end of Ceremony
⑫	Footpath West <sup>6</sup>	✓	 Cream	✓	×	2 per company (1 camera)	1 per company	7:20 am until end of Ceremony
⑬	Rear of the Choir Tent		 Brown	✓ (Includes local cable TV)	×	2 per company (1 camera)	—	7:20 am until end of Ceremony
	Cenotaph Northeast	✓				• 2 per company (1 camera) • 2 from rep. company (1 camera)	2 from rep. company (2 cameras)	
Members of the Press (Live broadcasters, etc.)		×	 White	✓	✓	White Press Passes will be issued to the minimum number of people necessary for members of the press (e.g., live broadcasters, liaisons) working in an area other than those described in 1 to 11 above.		In principle, no Press Area access from 7:20 am until end of Ceremony

<sup>1</sup> Please note the following:

- Entering or exiting Press Areas is not permitted during the specified times. (Outside these times, holders of Press Passes of all colors may enter for preparation purposes.)
- **Strictly no access from the central walkway to the Cenotaph or participant seating after 7:30 am** (excluding Navy Press Pass holders filming/photographing Press Area 10 (Central Walkway)).

<sup>2</sup> **As seating is limited, if we receive more applications than there are seats available, we may ask you to change Press Area.**

<sup>3</sup> Use of stepladders is not permitted. Furthermore, in consideration of Ceremony attendees, please only use the still photography camera stands provided when filming/photographing.

<sup>4</sup> A member of staff will guide members of the press during these portions of the program. **Please follow their instructions.**

<sup>5</sup> Please observe the following:

- Meet at the meeting point described on Map 3 **between 6:40 and 7:20 am (no entry to the museum after 7:20 am)**.  
If you need access to the museum before 6:40 am to set up equipment, please consult with the City of Hiroshima's Public

Relations Division in advance.

- **Bring and wear a helmet as well as fall arrest equipment (full-body safety harness).** Those not wearing helmets or fall arrest equipment will be refused permission to cover the Ceremony.
- **Do not film or photograph anything south of the park from the museum rooftop.**
- Note that when applying for a Press Pass for Press Area 7 (Museum Rooftop), applicants are required to also **submit a Written Pledge for Press coverage from the Peace Memorial Museum Rooftop (Attachment 2).**

<sup>6</sup> Use of stepladders is not permitted.

<sup>7</sup> During Addresses, members of the press will be directed to exit the Limited Access Area via the exit located south of the Central Walkway by staff members.

<sup>8</sup> Communal camera stands will be set up in the northern part of this area. However, please note that the use of stepladders is not permitted on these stands as they disrupt the sound from the loudspeakers.

### 3. Pre-Ceremony Coverage at the Cenotaph and Other Locations

(See Map 1-2 for details)

1. From 6:00 am until the end of the Ceremony, no filming, photography, or coverage is permitted in the Access Permitted Area (except for in designated Press Areas during the Ceremony). Additionally, please do not impede the movement of Cenotaph visitors.
2. Out of consideration for those paying their respects at the Cenotaph, you must not obstruct the view of the front of the Cenotaph at any time when filming.

### 4. Special Regulations for Coverage

1. Out of respect for the participants, we ask that members of the press wear appropriate clothing (for example, white dress shirts and black dress pants). Please note that only white face masks will be allowed. **If covering the Ceremony in Press Areas 3-6 (Triangle Area and Cenotaph Surroundings) and Press Area 10 (Central Walkway) detailed on Map 2, please be particularly mindful of this request.**
2. If you have any inquiries regarding Ceremony coverage, please confer with on-site City staff who are wearing the armband pictured right or are at the press reception desk.
3. Simultaneous interpretation in English via receiver will be available to journalists sitting in Press Area 1 (see Map 2). We ask that you collect your receiver, if necessary, from the press reception desk. **Please return the receiver to the press reception desk promptly following the end of the Ceremony.**
4. Please refrain from covering the Ceremony by air (camera drones included) between 7:40 am and 9:15 am on August 6, as it is disruptive to Ceremony proceedings and out of respect for the citizens of Hiroshima. Additionally, flying drones in Peace Memorial Park is prohibited.



広 報  
広島市

### 5. Traffic Restrictions on the Day of the Ceremony

(See Map 4 for details)

1. No traffic is permitted on Peace Boulevard (from the NHK building to west of Nishi-heiwa-ohashi) from 6:30 to 9:30 am on August 6. However, passage through the area designated by the arrows on Map 4 may be allowed for press organization vehicles that present the designated Traffic Pass. Please note that even vehicles that have presented the Traffic Pass may be denied passage due to security reasons.
  2. No access is permitted to Peace Memorial Park for the duration of the Ceremony; access will only be permitted after 10 am.
  3. A designated Traffic Pass will also be required for vehicular access to Peace Memorial Park from August 1 (Thurs) until the end of August 5 (Mon), as well as outside of traffic restriction times on the day of the Ceremony.
- Note: Excluding broadcast vans and power supply cars, no parking is permitted within Peace Memorial Park.**

## 6. Press Waiting Room

A Press Waiting Room will be set up in Ran 2 (2BF) of the ICCH between 6:30 am and 12 pm on Tuesday, August 6 (see Map 5). Please feel free to use the electrical sockets in the Press Waiting Room and wireless access points for the Internet. You can also use the Wi-Fi in the lobby in front of the Dahlia Room on the same floor.

Press Waiting Room network	SSID: icch-wifi	Password: icch2427777
Lobby network	SSID: icch-free	Password: icc-h

### Note:

- Please be responsible for your own valuables.
- Please take all trash with you when you leave.

## 7. Free Download of Pictures

Official photographs taken by the City of Hiroshima in Press Area 3 (Triangle Area) will be made available via our website; please feel free to download any you need.

- The website URL and file password will be provided when we issue Press Passes.
- File format: JPEG
- Photographs will be available from 12 pm, Tuesday, August 6 (tentative) until 5 pm, Saturday, August 31.
- When using official City of Hiroshima photographs, we ask that you give credit by including "Provided by the City of Hiroshima."

Previous photographs (2023):





# Limited Access Area

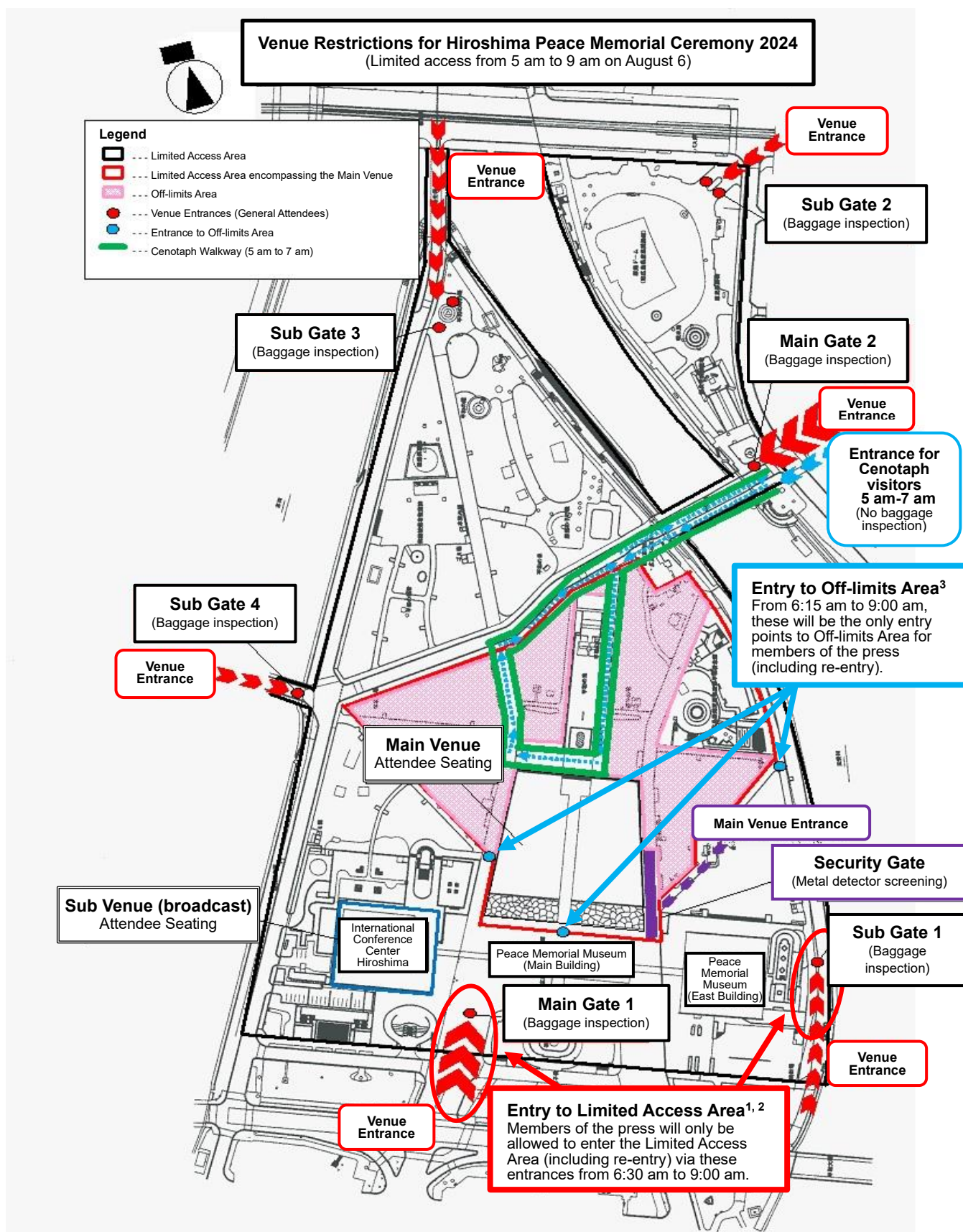

<sup>1</sup>Entry via the Main Gates and Sub Gates between 5:00 am and 6:30 am is permitted.

<sup>2</sup>Please use the Guest Entrance at Main Gate 1 or the Priority Entrance at Sub Gate 1.

<sup>3</sup>Entry via the entrance located south of the Central Walkway is prohibited between 7:20 am and 9 am.

<sup>4</sup>Venue restrictions are subject to change. Please follow the instructions of our staff on the day.

## Ceremony Coverage at the Cenotaph and Other Locations

**Coverage is permitted until 6 pm on August 6 (Tues).** Filming/photographing after this time is disruptive to those paying their respects. **Please strictly respect the time limit.**

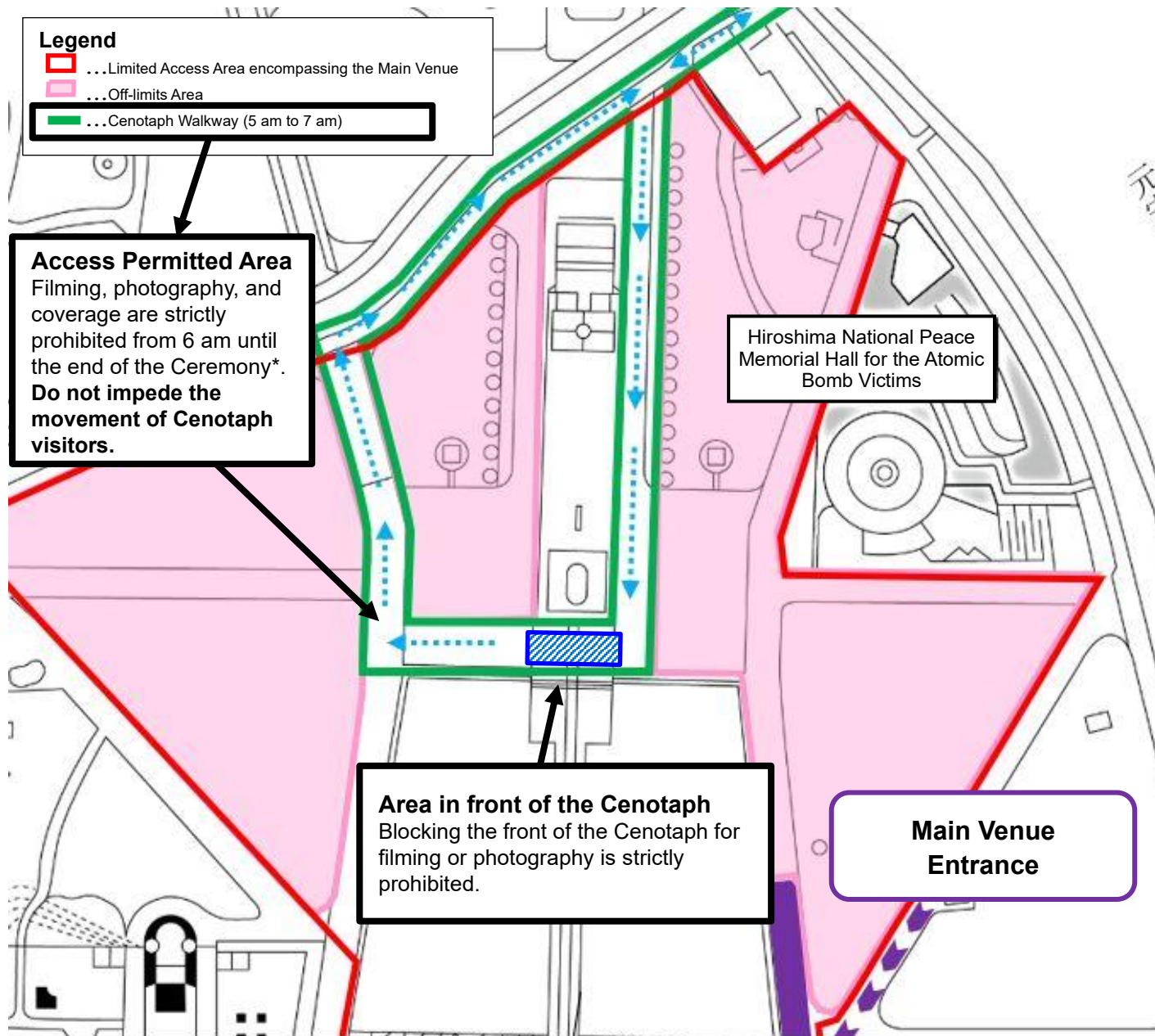

\*Members of the press may only film/photograph from areas outside of the Cenotaph Walkway from 6:00 am until the end of their respective Restricted Movement Periods.

# Site Plan for the Hiroshima Peace Memorial Ceremony (Press Areas)

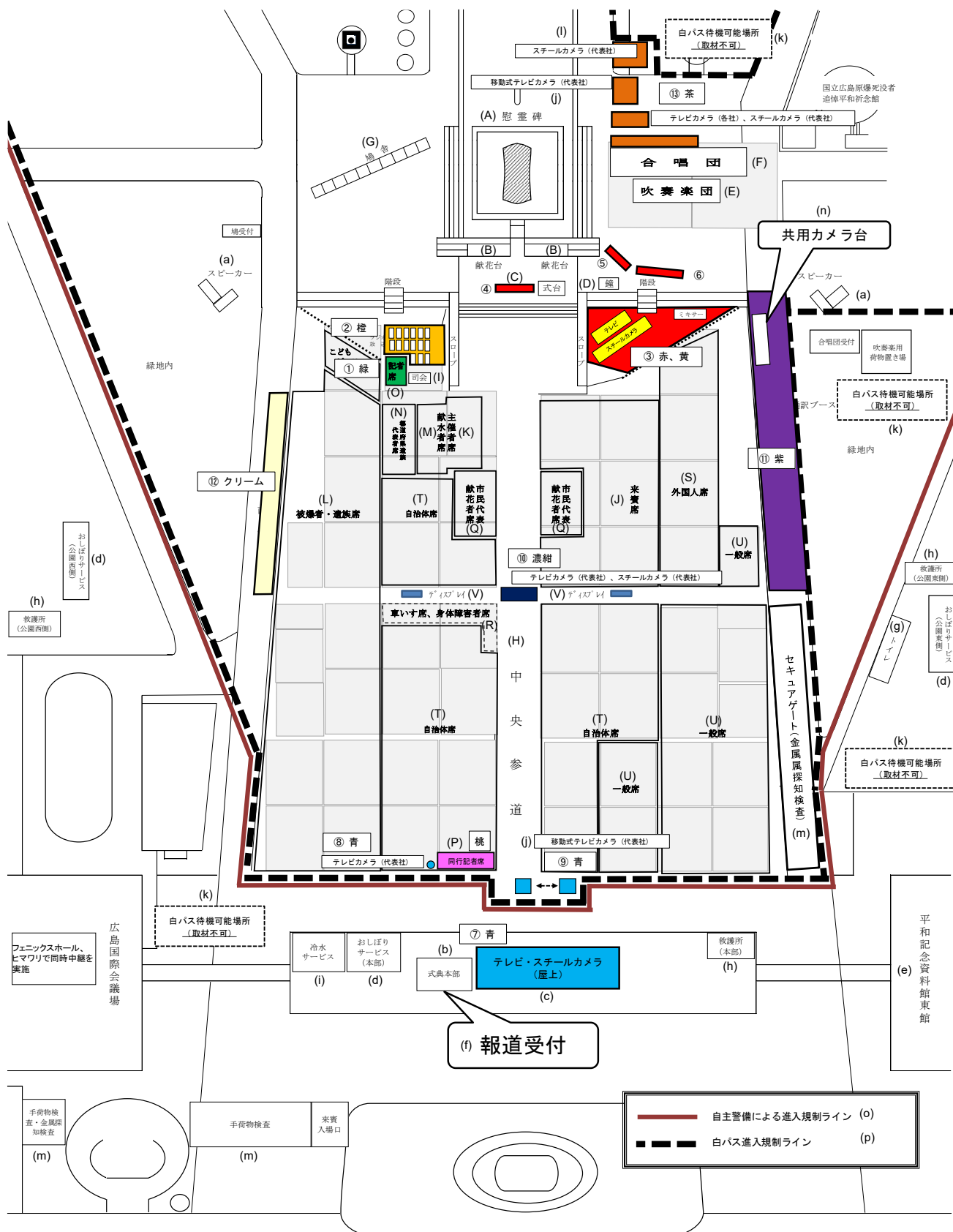

## Note:

- Entering or exiting a Press Area is not permitted during its Restricted Movement Period.
- Venue restrictions are subject to change. Please follow the instructions of staff on the day.

# Site Plan for the Hiroshima Peace Memorial Ceremony (Press Areas)

## Key to Map 2

1 to 11: Press Areas by Press Pass color

①	②	③	④ ⑤ ⑥	⑦ ⑧	⑨	⑩	⑪
Green	Orange	Red/Yellow	Red	Blue	Blue	Navy	Purple

- (A) Cenotaph for the A-bomb Victims
- (B) Wreath stands
- (C) Podium
- (D) Peace Bell
- (E) Wind Orchestra
- (F) Choir
- (G) Doves
- (H) Central Walkway
- (I) Master of ceremonies
- (J) Seats for distinguished guests
- (K) Seats for City officials
- (L) Seats for *hibakusha* and bereaved families
- (M) Seats for those making a ceremonial offering of water
- (N) Seats for bereaved families from outside Hiroshima
- (O) Seats for journalists
- (P) Seats for journalists accompanying the prime minister
- (Q) Seats for Hiroshima citizen representatives dedicating flowers
- (R) Seats for *hibakusha* and bereaved families with disabilities and/or in wheelchairs
- (S) Seats with simultaneous interpreting
- (T) Seats for representatives of other municipalities
- (U) Seats for the general public
- (V) Displays

- (a) Loudspeakers
- (b) Ceremony HQ
- (c) Peace Memorial Museum (Rooftop)
- (d) Cold towels (Ceremony HQ)
- (e) Peace Memorial Museum (East Building)
- (f) **Press reception**
- (g) Portable toilets
- (h) First aid station (Ceremony HQ)
- (i) Cold water station
- (j) Mobile TV camera (representative company)
- (k) White Press Pass holder standby points (**no coverage permitted**)
- (l) Still photography camera (representative company)
- (m) Security checkpoints (baggage and metal detection screenings)
- (n) Communal camera stands
- (o) Limited Access Area (supervised by city hall staff)
- (p) Limited Access Area (white Press Pass holders)



## Press Area 7 (Museum Rooftop) Meeting Point

Peace Memorial Museum East Building 1F Floor Plan

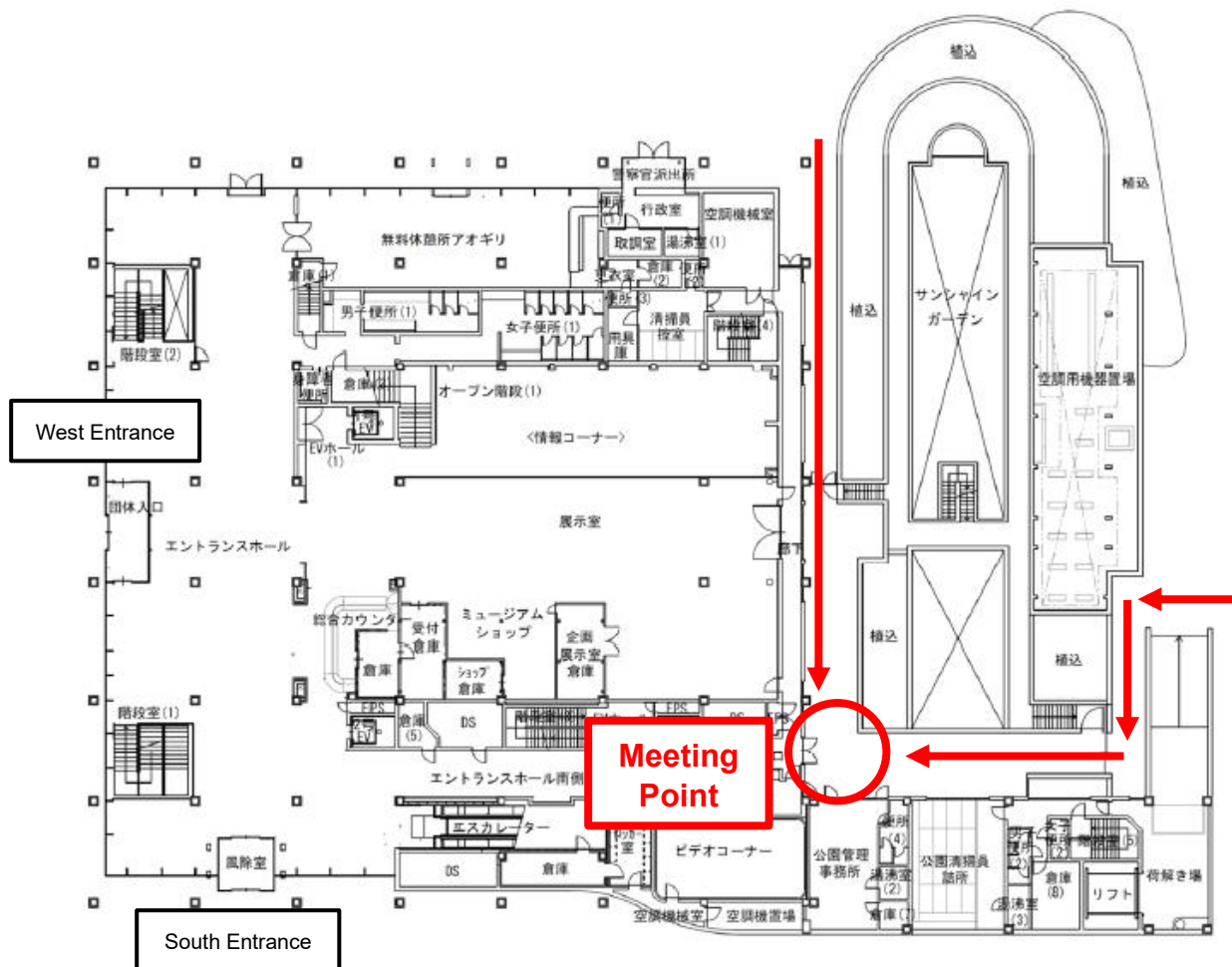

- Please meet at the meeting point between 6:40 am and 7:20 am (no entry to the museum after 7:20 am). If you need access to the Museum before 6:40 am to set up equipment, please consult with the City of Hiroshima's Public Relations Division in advance.
- Please bring and wear a helmet as well as fall arrest equipment (full-body safety harness). Those not wearing helmets or fall arrest equipment will be refused permission to cover the Ceremony.
- You will be led from the meeting point to the Peace Memorial Museum rooftop by a staff member.

## August 6 Traffic Restrictions

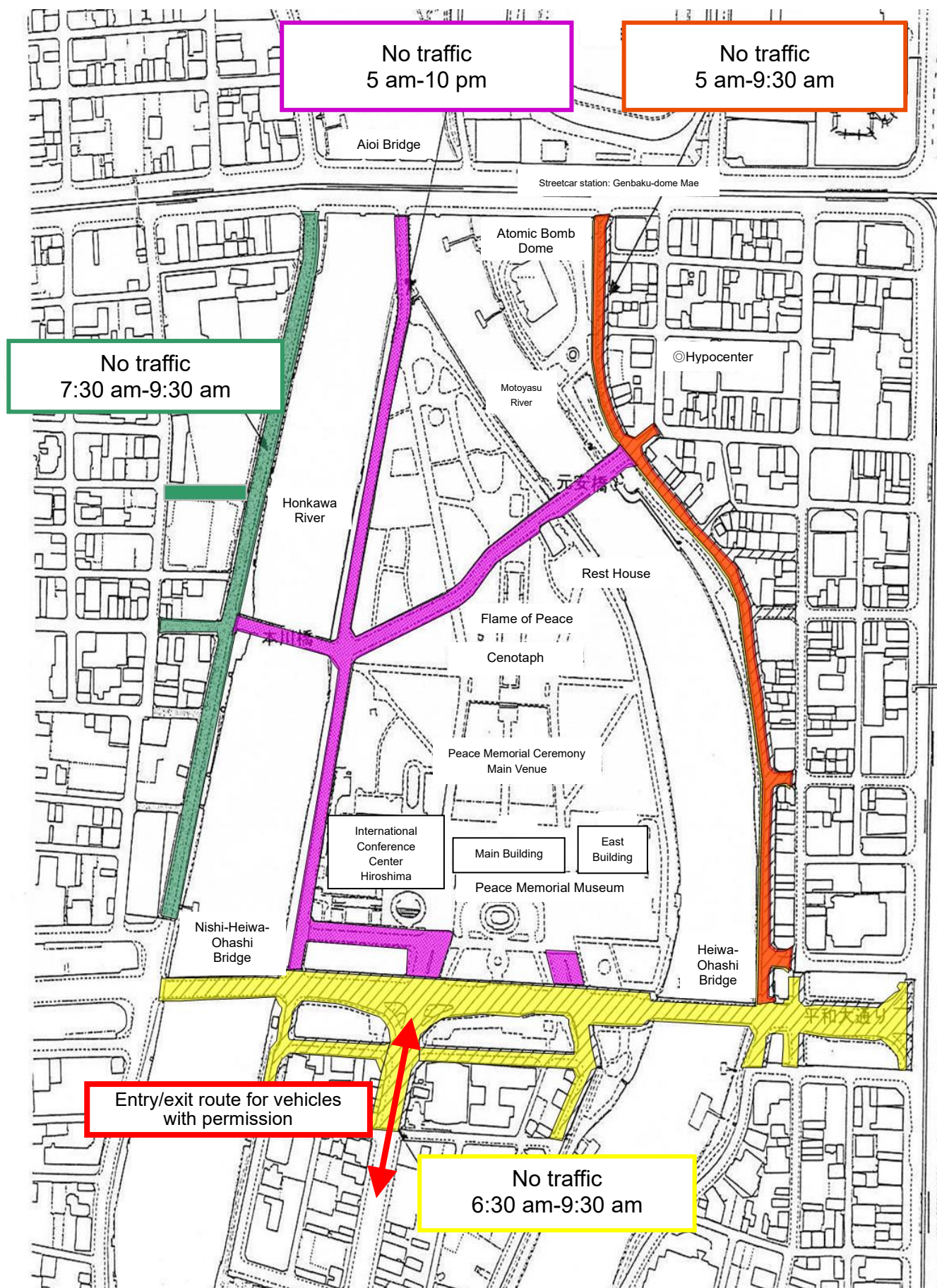

## Press Waiting Room (International Conference Center Hiroshima)

Use of the Press Waiting Room is permitted between 6:30 am and 12 pm on August 6 (Tues).

**Please ensure you leave by 12 pm.**

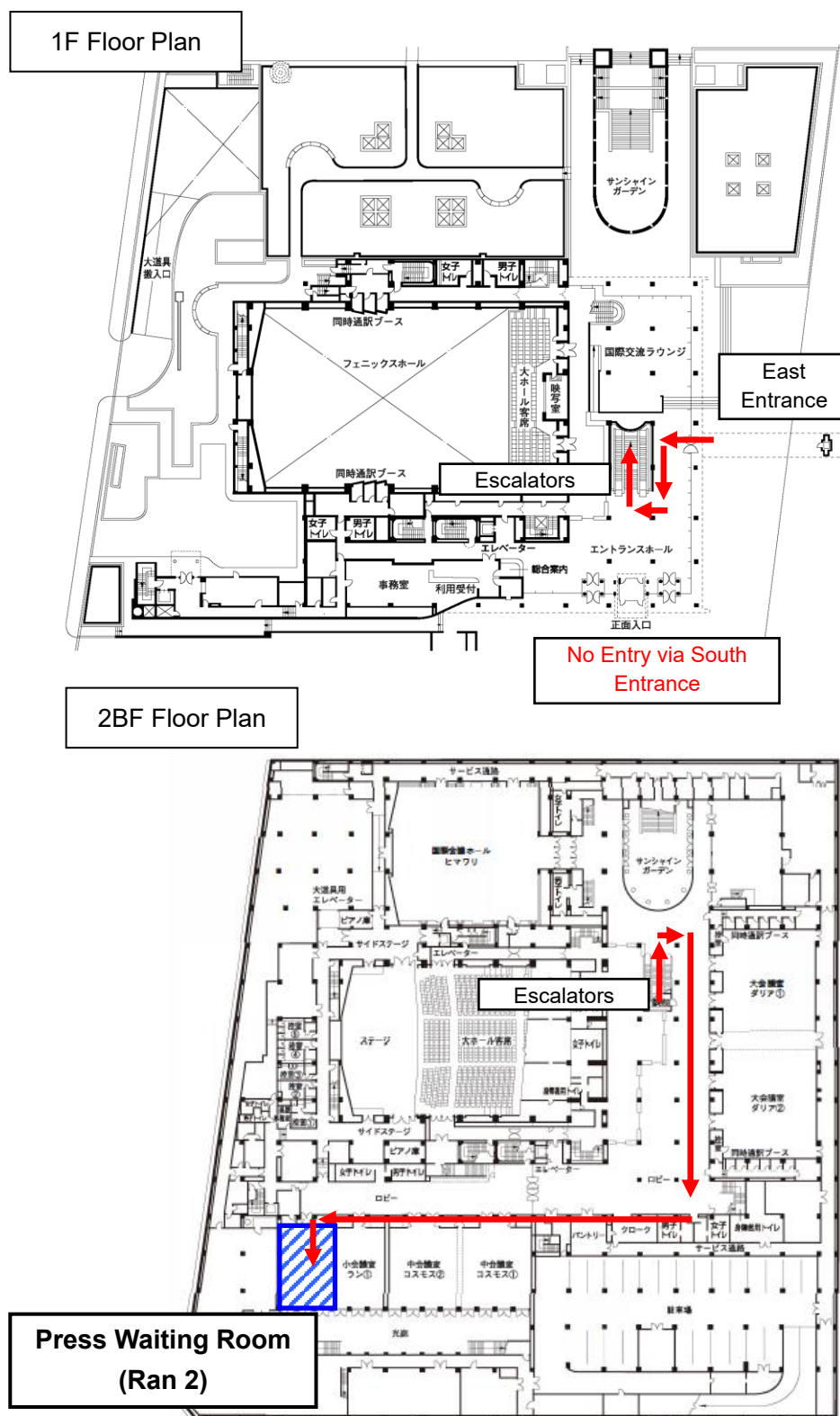

- Please be responsible for your own valuables.
- Please take all trash with you when you leave.



Submit this application and direct any inquiries to:  
Public Relations Division  
Planning and General Affairs Bureau  
The City of Hiroshima  
Tel: (+81) 82-504-2116  
Email: pr-koho@city.hiroshima.lg.jp

(Attachment 1)

## Press Coverage Application Form

I hereby submit a formal request to cover the Peace Memorial Ceremony.

By signing this form, I declare that I will follow all press regulations and will not hinder, obstruct, or otherwise interfere with the progress of the Ceremony. I also pledge to keep coverage within moderation and be considerate of the feelings of the participants.

I also agree that the City of Hiroshima may present any documents I submit to the police or a similar organization for security purposes.

Date \_\_\_\_\_, 2024 Print Name \_\_\_\_\_

Signature \_\_\_\_\_

<b>Company or Organization Name</b>			
<b>Country of Headquarters</b>	<input type="checkbox"/> Japan <input type="checkbox"/> Other: _____	<b>Classification</b>	<input type="checkbox"/> Newspaper <input type="checkbox"/> News Agency <input type="checkbox"/> TV <input type="checkbox"/> Other: _____
<b>Membership</b>	<input type="checkbox"/> Japan Newspaper Publishers and Editors Association <input type="checkbox"/> National Association of Commercial Broadcasters in Japan <input type="checkbox"/> Member of the Hiroshima City Press Club <input type="checkbox"/> Foreign Press in Japan <input type="checkbox"/> Foreign media organization that applied via the Foreign Press Center <input type="checkbox"/> Other: _____		
<b>Contact Information</b>	Address: _____		Tel: _____
	Cellphone number (applicant): _____		Fax: _____

Name(s)	Position	Press Pass (Color)
(Group Representative)	<input type="checkbox"/> Journalist <input type="checkbox"/> Camera Operator	<input type="checkbox"/> Green <input type="checkbox"/> Purple <input type="checkbox"/> White
1	<input type="checkbox"/> Assistant Camera Operator	
2	<input type="checkbox"/> Journalist <input type="checkbox"/> Camera Operator	<input type="checkbox"/> Green <input type="checkbox"/> Purple <input type="checkbox"/> White
	<input type="checkbox"/> Assistant Camera Operator	
3	<input type="checkbox"/> Journalist <input type="checkbox"/> Camera Operator	<input type="checkbox"/> Green <input type="checkbox"/> Purple <input type="checkbox"/> White
	<input type="checkbox"/> Assistant Camera Operator	
4	<input type="checkbox"/> Journalist <input type="checkbox"/> Camera Operator	<input type="checkbox"/> Green <input type="checkbox"/> Purple <input type="checkbox"/> White
	<input type="checkbox"/> Assistant Camera Operator	
5	<input type="checkbox"/> Journalist <input type="checkbox"/> Camera Operator	<input type="checkbox"/> Green <input type="checkbox"/> Purple <input type="checkbox"/> White
	<input type="checkbox"/> Assistant Camera Operator	
6	<input type="checkbox"/> Journalist <input type="checkbox"/> Camera Operator	<input type="checkbox"/> Green <input type="checkbox"/> Purple <input type="checkbox"/> White
	<input type="checkbox"/> Assistant Camera Operator	

<b>Representative's Contact Information</b>	Cellphone number	
	Email	

Press Passes	Press Area (Color)	① Journalists	⑨ Footpath East	Press (Broadcasters, etc.)	Total
		Green	Purple	White	
	No. of Passes				

(For Public Relations Division Use Only)

受付日	(担当: _____)	交付日	(担当: _____)
-----	-------------	-----	-------------



## Written Pledge

\_\_\_\_\_, 2024  
Date

To: MATSUI Kazumi  
Mayor  
The City of Hiroshima

\_\_\_\_\_  
Company Name

With regard to press coverage from the Peace Memorial Museum rooftop,  
\_\_\_\_\_ hereby makes the following pledge:

(Company Name)

- (1) To take precautions against damaging any property as a result of press coverage.
- (2) To immediately report any damage that has resulted from our actions to the facility administrator.
- (3) To accept responsibility for restoring any damaged property to its original condition.
- (4) To accept total responsibility for any and all injuries sustained by third parties caused by our actions.
- (5) To accept total responsibility for any and all injuries incurred by members of our own staff in the course of our coverage activities.

<b>This page is only applicable for member companies of the City Press Club.</b>
--

## 平和関連用語の正式名称について

平和記念施設等の正式名称は下記のとおりとなっていますので、ご確認ください。

【使用例】	【正式名称】
原爆記念日／原爆忌	平和記念日
平和祈念式／8・6式典	広島市原爆死没者慰霊式並びに平和祈念式 (総称：平和記念式典)
平和公園	平和記念公園
原爆慰霊碑	原爆死没者慰霊碑（広島平和都市記念碑）
原爆資料館	広島平和記念資料館
追悼平和祈念館	国立広島原爆死没者追悼平和祈念館
過去帳	原爆死没者名簿
原爆手帳／被爆者手帳	被爆者健康手帳
供養塔	原爆供養塔
語り部	被爆体験証言者

**This is a list of Japanese official names  
for terms and facilities related to the  
Hiroshima Peace Memorial Ceremony.**

Please direct inquiries regarding the Press  
Coverage Regulations to:  
Public Relations Division  
Planning and General Affairs Department  
The City of Hiroshima  
1-6-34 Kokutaiji-machi, Naka-ku  
Hiroshima, Japan 730-8586  
**Tel:** (+81) 82-504-2116  
**Fax:** (+81) 82-504-2067  
**Email:** [koho@city.hiroshima.lg.jp](mailto:koho@city.hiroshima.lg.jp)